

■ Fire Safety

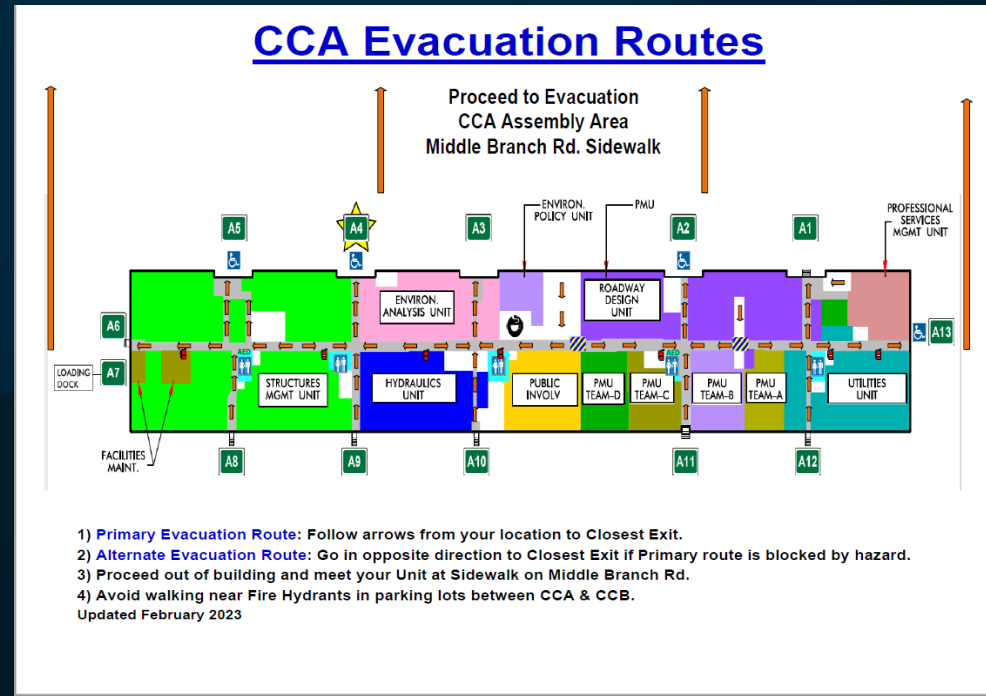

■ Emergency Action Plans- office

- How do we report emergencies or get assistance?
- What does the alarm sound like?
- What are my primary and secondary exit routes?
- How do we report a missing person?





- Emergency Action Plans

What is the most important safety feature in an emergency?

Knowing your exit routes

■ Fire Protection

- On average you only have minutes to evacuate
- Depending on fire chemistry, many toxic gasses & smoke are produced. These gasses can incapacitate or kill with only one breath
- ALWAYS look for a way out!

Fire Deaths

66% - smoke

33% - heat

1% - other





NORTH CAROLINA

Department of Transportation



Fire Protection

Fire Extinguishers located throughout NCDOT facilities shall be.....

Mounted, located and identified to be readily accessible.
“Approved.” Fully charged and operable, in designated location.

Training is required before you operate a fire extinguisher.

Sprinklers may also be used in conjunction with fire extinguishers

How to Operate a Fire Extinguisher (P.A.S.S.)

Next we are going to learn how to operate a fire extinguisher using the P.A.S.S method.



■ Fire Protection

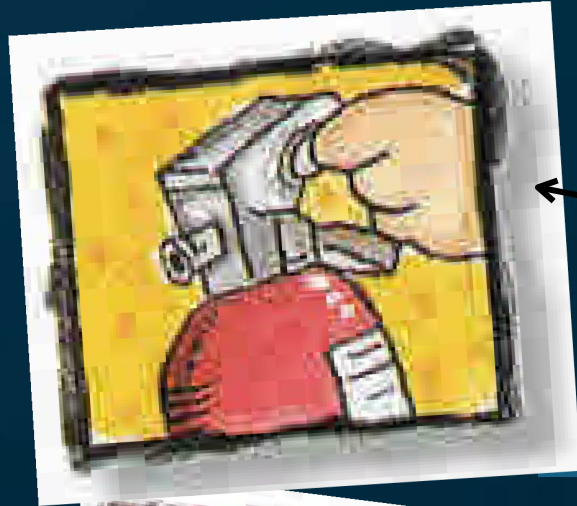

Pull



Aim



Squeeze



Sweep